

Instruction Sheet

12-892-05-RK HIGH-TEMPERATURE EXHAUST GAS RECIRCULATION (EGR) CORE PULLER SERVICE KIT







4328290R1

Application

MaxxForce® 11 and 13 (EPA 10)

Kit Contents

Table 1

Image	Tool Number	Qty	Description
	12-892-05-08	1	Threaded Bushing
	12-892-05-10	1	Weldment-Acme Rod
	12-892-05-service	1	Bearing and Cup Kit Contains: <ul style="list-style-type: none">• 2 Needle Roller Bearings• 4 Needle Bearing Washers• 1 Thrust Collar• 1 Thrust Collar Set Screw• 1 Bearing Housing• 4 Collar Screws
 0000160075	4328290R1	1	Instruction Sheet

! WARNING: To prevent personal injury and / or death, always wear safe eye protection when performing vehicle maintenance.

Procedure

Inspection



0000366401

Figure 1. Damaged Puller Plate.

1. Puller plate

NOTE: If puller plate is bent or damaged, the tool will need to be replaced. DO NOT attempt to repair a tool with a damaged puller plate.

1. Inspect puller plate (Figure 1, Item 1) for any damage.

Removal

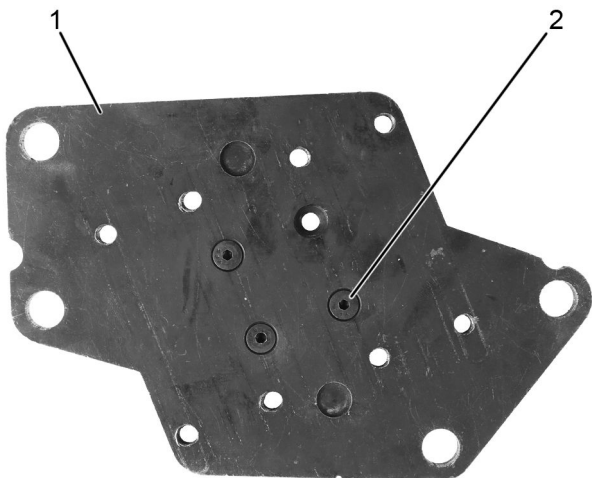

0000365241

Figure 2. Removal Plate and Bolts.

1. Removal plate
2. Bolt (4) (1 not shown).

1. Use an allen wrench to remove bolts (Figure 2, Item 2) that attach removal plate (Figure 2, Item 1) to bearing housing.

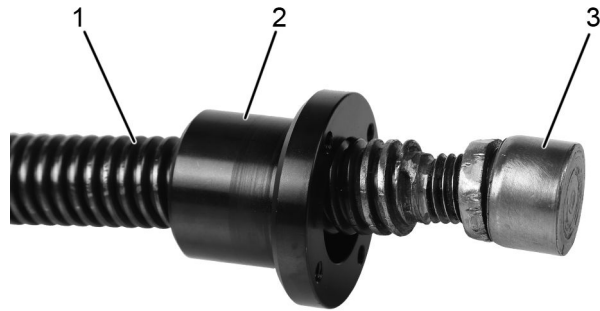

0000365541

Figure 3. Bearing Housing, Rod, and Foot.

1. Rod
2. Bearing housing
3. Foot

2. Remove removal plate from the rod (Figure 3, Item 1).
3. Remove foot (Figure 3, Item 3) from rod.
4. Remove bearing housing (Figure 3, Item 2) from rod.
5. Remove washers, if any, from rod.

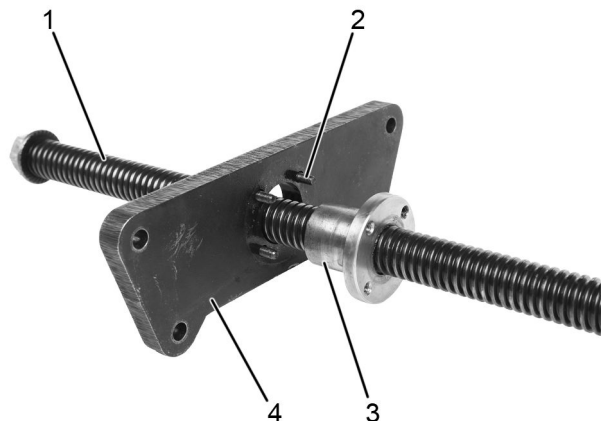

0000365261

Figure 4. Threaded Bushing and Screws.

1. Rod
2. Screw (4) (1 not shown)
3. Threaded bushing
4. Removal plate

NOTE: Save bolts for reuse.

Removal (cont.)

6. Remove screws (Figure 4, Item 2) from threaded bushing (Figure 4, Item 3).
7. Remove threaded bushing from rod (Figure 4, Item 1). If bushing does not slide off the rod easily, cut or grind the rod.
8. Remove removal plate (Figure 4, Item 4) from rod.

Installation

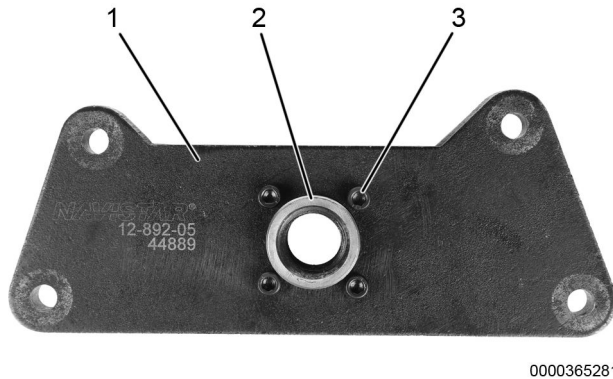

Figure 5. Removal Plate, Threaded Bushing, and Screws.

1. Removal plate (with writing)
 2. Threaded bushing
 3. Screw (4)
1. Insert threaded bushing (Figure 5, Item 2) into removal plate (Figure 5, Item 1).
- NOTE: Verify that the writing on the removal plate faces towards the end of the rod that has the nut.**
2. Install screws (Figure 5, Item 3) that attach bushing to puller plate. Hand-tighten screws to 75 in-lb (8.4 N•m).

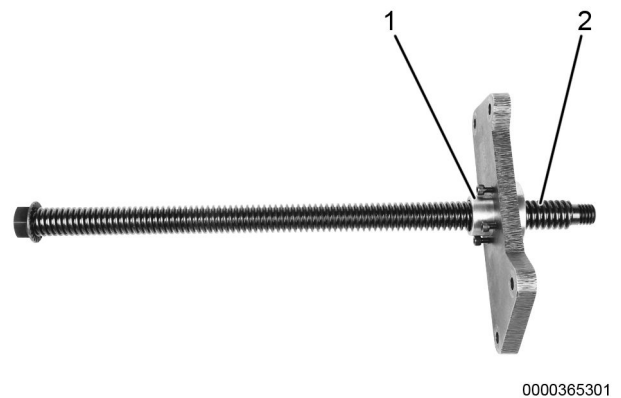

Figure 6. Removal Plate, Rod, and Bushing.

1. Threaded bushing
2. Rod

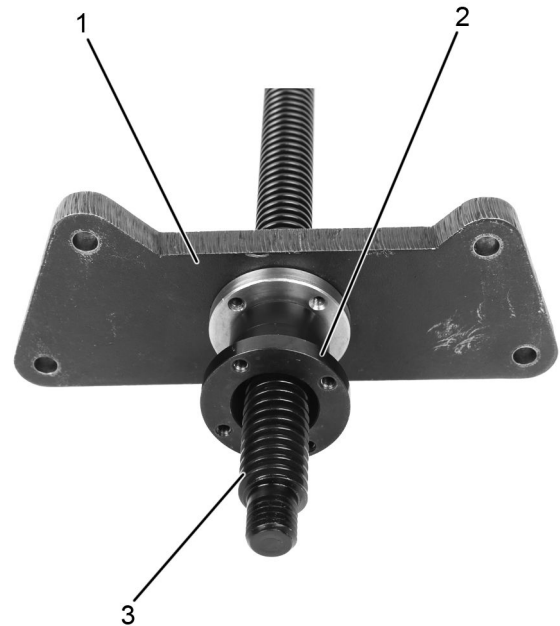

Figure 7. Bearing Housing.

1. Removal plate
 2. Bearing housing
 3. Rod
3. Insert rod (Figure 6, Item 2) into bushing (Figure 6, Item 1).
 4. Install bearing housing (Figure 7, Item 2) to rod (Figure 7, Item 3).

Installation (cont.)

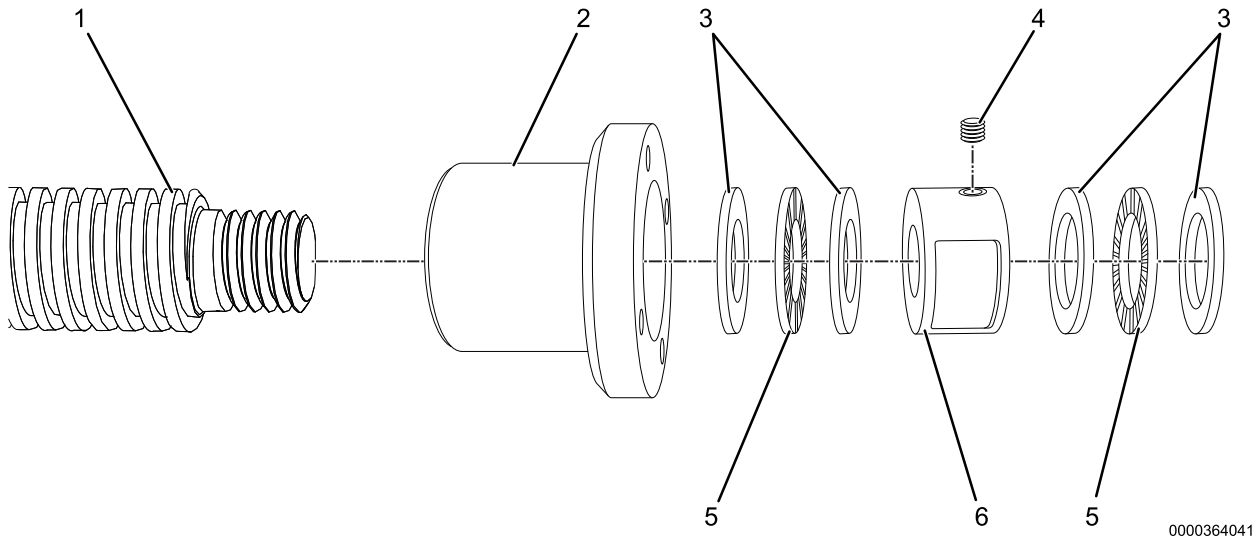
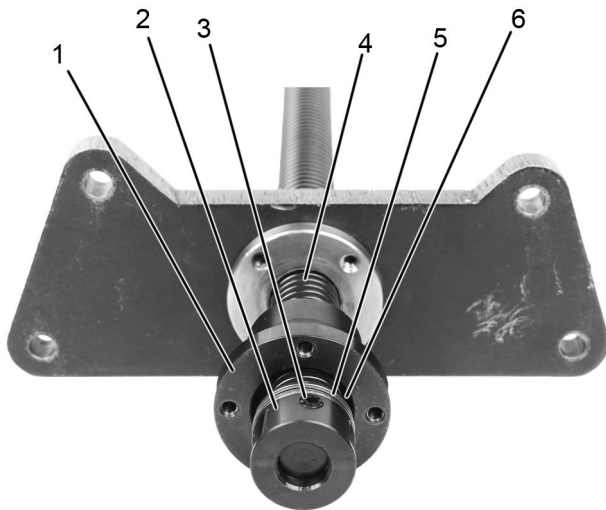

Figure 8. Assembly Order.

- | | | |
|--------------------|---------------|------------------|
| 1. Rod | 3. Washer (4) | 5. Bearing (2) |
| 2. Bearing housing | 4. Set screw | 6. Thrust collar |



0000365402

Figure 9. Thrust Collar, Bearings, and Washers.

1. Bearing housing
2. Thrust collar
3. Thrust collar set screw
4. Rod
5. Needle roller bearing
6. Needle bearing washer

5. Install washer (Figure 8, Item 3), bearing (Figure 8, Item 5), and washer to rod (Figure 9, Item 4).
6. Insert set screw (Figure 8, Item 4) into collar (Figure 8, Item 6).
7. Verify that bearings are able to move freely, without obstruction.
8. Lubricate bearing.
9. Verify that bearing housing (Figure 9, Item 1) moves freely, without obstruction, over washers, bearing, and collar.

Installation (cont.)

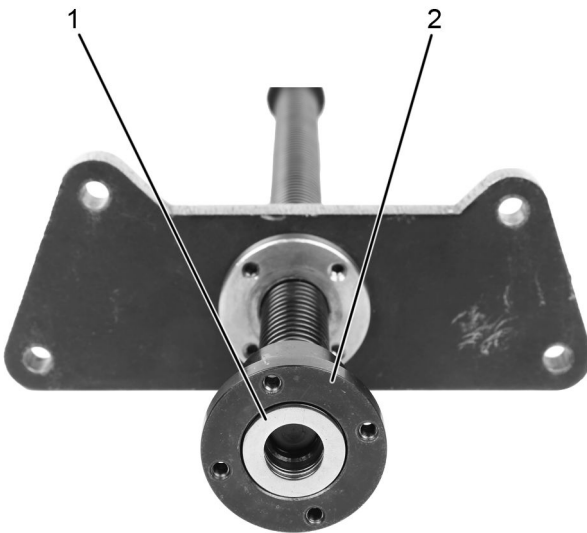

0000365403

Figure 10. Washers and Bearings Inside Bearing Housing.

1. Needle bearing washer
2. Needle roller bearing (Not shown)
3. Bearing housing

NOTE: Hold bearing housing over the thrust collar when installing washers and bearing.

10. Install washer (Figure 10, Item 1) to rod.

11. Lubricate bearing (Figure 10, Item 2), then install it to rod on top of washer.

12. Install washer to rod.

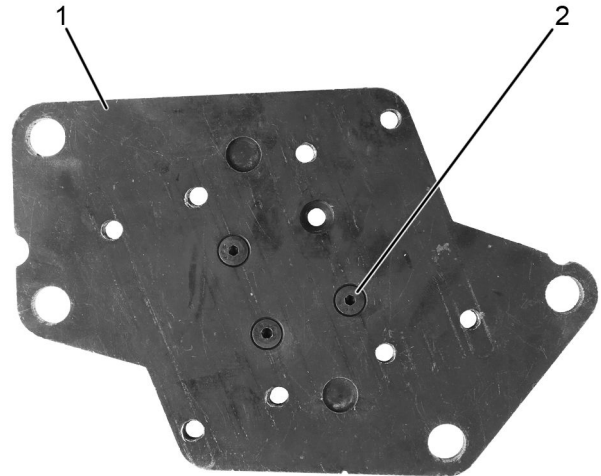

0000365241

Figure 11. Removal Plate and Screws.

1. Removal plate
2. Screw (4) (1 not shown)

13. Insert screws (Figure 11, item 2) into removal plate (Figure 11, item 1). Hand-tighten screws to 75 lb-in (8.4 N•m).