

## Tool Instruction Crankshaft Seal Installer Update

4328477R1

---

Tool Number: ZTSE4875 (REV 786)



0000414092

Figure 1. Crankshaft Seal Installer Outer Cup

### Purpose

**IMPORTANT:** Service Managers, this update includes a new outer cup for the current rear crankshaft seal installer (ZTSE4875) which is specific in size and length to accommodate the crankshaft seal found on 2007 and newer 11 and 13 liter engines, as well as the International<sup>®</sup> A26. To avoid engine / component damage, it is important to discard the old outer cup and use only the new revised outer cup. This outer cup is backwards compatible.

## Purpose (cont.)

This includes a new outer cup clearly marked with ZTSE4875 REV 786, which is to replace the existing outer cup on the ZTSE4875 rear seal installer. This update is backwards compatible with all applications. Please remove current outer cup and discard. Failure to use the revised cup will cause high risk to engine and component damage.

## Application(s)

2017 International® A26  
 2015 N13 with SCR  
 2013 N13 with SCR  
 2010 Maxxforce® 11 and 13  
 2007 Maxxforce® 11 and 13



**! WARNING:** To prevent personal injury and / or death, read all safety instructions in the “Safety Information” section of the *Engine Service Manual* or *Engine Diagnostic Manual* .

**! WARNING:** To prevent personal injury and / or death, always wear safe eye protection when performing vehicle maintenance.

**! CAUTION:** To prevent engine / component damage, only use the crankshaft seal installer outer cup included in this update to install crankshaft seals.

## Tool Contents

Table 1

Image	Tool Number	Qty	Description
 <p>0000414090</p>	ZTSE4875 (REV 786)	1	Outer Cup
 <p>0000160075</p>	4328477R1	1	Tool Instruction

## Instructions

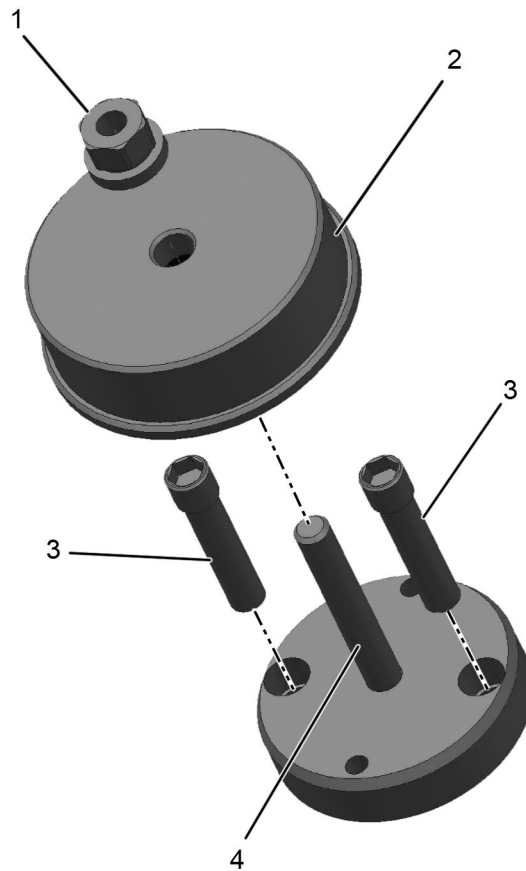

0000414094

**Figure 2. Crankshaft Seal Installer**

1. Retaining nut / washer / bearing
2. Outer cup
3. Mounting bolt (2)
4. Outer cup stud

**CAUTION:** To prevent component damage, ensure to remove and discard the existing outer cup.

**NOTE:** Do not discard the mounting bolts.

1. Locate tool kit number ZTSE4875 Rear Crankshaft Seal Installer Kit.
2. Remove retaining nut, washer, and bearing from outer cup stud (Figure 2, Items 1 & 4).
3. Remove outer cup (Figure 2, Item 2). Ensure mounting bolts (Figure 2, Item 3) are not removed or discarded.

## Instructions (cont.)



0000414293

**Figure 3. Crankshaft Seal Installer Cup Comparison**

1. ZTSE4875 – Outer cup
2. ZTSE4875 (REV 786) – Outer cup

**NOTE: ONLY discard outer cup marked ZTSE4875.**

4. Discard existing outer cup (Figure 3, Item 1).
5. Replace with supplied outer cup (Figure 3, Item 2).
6. Assemble outer cup on outer cup stud.
7. Reassemble bearing, washers and nut. Tighten retaining nut to outer cup stud.

### Contact Information

If you would like to order additional tools or need replacement parts, please refer to the Navistar Service Tool Catalog. If you have questions, concerns, or feedback, please contact Navistar Service Tool Support Center:

- Submit a Service Tool iKnow Case File.
- Phone: 800-365-0088 (toll free).